

**NOTES (UNLESS OTHERWISE SPECIFIED):**

1. Material: UNS S30400;  
Thickness: .0595 (16 GA)
2. The following standards are invoked:  
ASME B46.1-2019, ASME Y14.5-2018,  
ASME Y14.36-2018, ASME Y14.41-2019.
3. Specifications in the Specifications table are invoked.
4. Tolerances and requirements in the Global Tolerances block are invoked.
5. Information assets in the Official Information Assets table are invoked.
6. Explicit dimensions are the official definition of the product geometry they define.  
  
Model geometry is the official definition of all other product geometry.
7. Model geometry represents basic dimensions except for the following:
  - Explicitly dimensioned geometry
  - Bend radius size
8. A-Side surfaces are defined in model data.  
A-Side surfaces may be visually indicated by query. Trim edges are not defined as A-Side surfaces.
9. Clean and passivate per ASTM A967.
10. Mark using indicated characters and heights in location shown.
11. Length units: Inches

- Geometry defined as reference

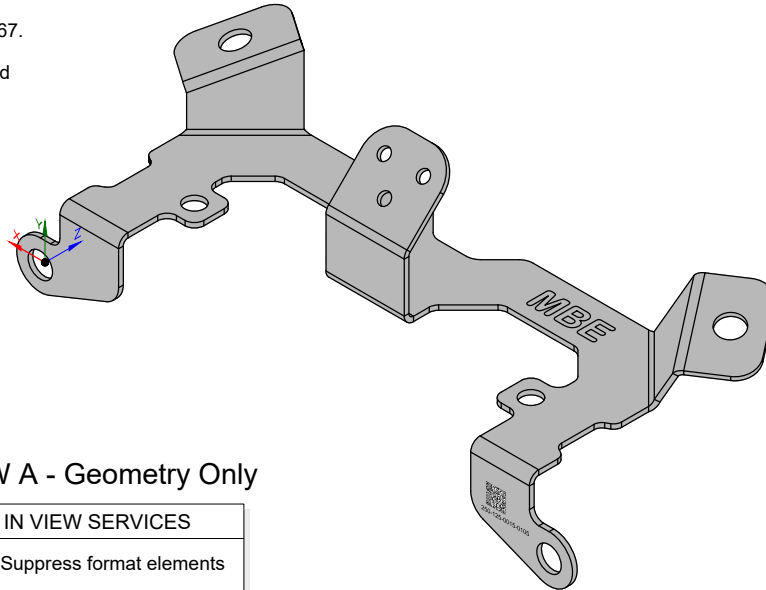

VIEW A - Geometry Only

APPROVALS:		DATE:
DRAWN:	BR FISCHER	04JULY2023
CHECKED:	BR FISCHER	04JULY2023
ENGINEER:	BR FISCHER	04JULY2023
MODEL NO:	250-125-0015-0105-5.2	CAD KaijuCAD
PART NO:	250-125-0015-0105	REV: A
TITLE: Bracket, Mtg - Proximity Sensor		
DATASET CLASSIFICATION CODE:		DCC 5
DATASET USE CODE:		DUC 5.2
WORK MODE:		MBE
STRUCTURE:		Minimally-Dimensioned Model
General Metadata		1 of 3

GLOBAL TOLERANCES
Global Datum Reference Frame [A][B][C]
Product State: Restrained. Tolerances apply per IP-250-125-0015-0114_A.
Global Profile Tolerance: [0.06][A][B][C]
Unless otherwise specified, global profile tolerance applies to all untoleranced A-side surfaces that are not features of size.
Explicit geometric tolerances applied to A-Side surfaces or to surfaces opposing A-Side surfaces are otherwise specified.
Global Positional Tolerance: [0.06][A][B][C]
Applies to all untoleranced features of size.
Global Size Tolerance: ±.008 Applies to all untoleranced features of size.
Bend Radius Tolerance: ±.02 Applies to all bends.

IN VIEW SERVICES
<input type="checkbox"/> Suppress format elements
<input type="checkbox"/> Enable view controls
<input type="checkbox"/> Full screen
<input type="checkbox"/> Markup
<input type="checkbox"/> Save view
<input type="checkbox"/> Recall / Export view
<input type="checkbox"/> Display bounding box
<input type="checkbox"/> Lock view

Bounding Box  
x = (7.325)  
y = (2.547)  
z = (2.965)



SPECIFICATIONS	
TDP-SCR-01_A	Security, copyright, and rights in use
TDP-CC-01_A	Product definition dataset classifications
TDP-CTG-01_A	Coating and finish requirements and conformance
TDP-M-01_A	Modeling modeling practices, data objects, dataset structure and schema(s)
TDP-MK-01_A	Product marking and identification
TDP-OP-01_A	Finished item operational requirements and conformance
TDP-UC-01_A	Officially approved use cases for official information and information assets
TDP-WK-01_A	Finished item workmanship requirements and conformance

INFORMATION SERVICES
<input type="checkbox"/> Display security, export control, trademark, patent, proprietary, and rights in use information
<input type="checkbox"/> Display critical safety and handling information
<input type="checkbox"/> Display information asset (IA) map, legend, modeling, schema, product, and IA information
<input type="checkbox"/> Display KPC / KPI and critical item information
<input type="checkbox"/> Display other special notations and information
<input type="checkbox"/> Display global datum features
<input type="checkbox"/> Display global setup and interface information
<input type="checkbox"/> Display surface preparation and requirements
<input type="checkbox"/> Display feature-level information
<input type="checkbox"/> Markup / Save full format view
<input type="checkbox"/> Recall / Export saved full format view
<input type="checkbox"/> Display last revision information
<input type="checkbox"/> Display data and dataset validation scoring

OFFICIAL INFORMATION ASSETS				REVISION HISTORY				
ITEM	ASSET TYPE	ASSET NUMBER	ASSET DESCRIPTION	ZONE	REV	DESCRIPTION	DATE	APPROVED
1	Model	250-125-0015-0105-5.2	Bracket, Mtg - Proximity Sensor Model		A	Production Release	5/01/2023	-
-	-	-	-	-	-	-	-	-
-	-	-	-	-	-	-	-	-

APPROVALS:	DATE:
DRAWN: BR FISCHER	04JULY2023
CHECKED: BR FISCHER	04JULY2023
ENGINEER: BR FISCHER	04JULY2023
MODEL NO: 250-125-0015-0105-5.2	CAD KaijuCAD
PART NO: 250-125-0015-0105	REV: A
TITLE: Bracket, Mtg - Proximity Sensor	
DATASET CLASSIFICATION CODE:	DCC 5
DATASET USE CODE:	DUC 5.2
WORK MODE:	MBE
STRUCTURE:	Minimally-Dimensioned Model

General Metadata 2 of 3

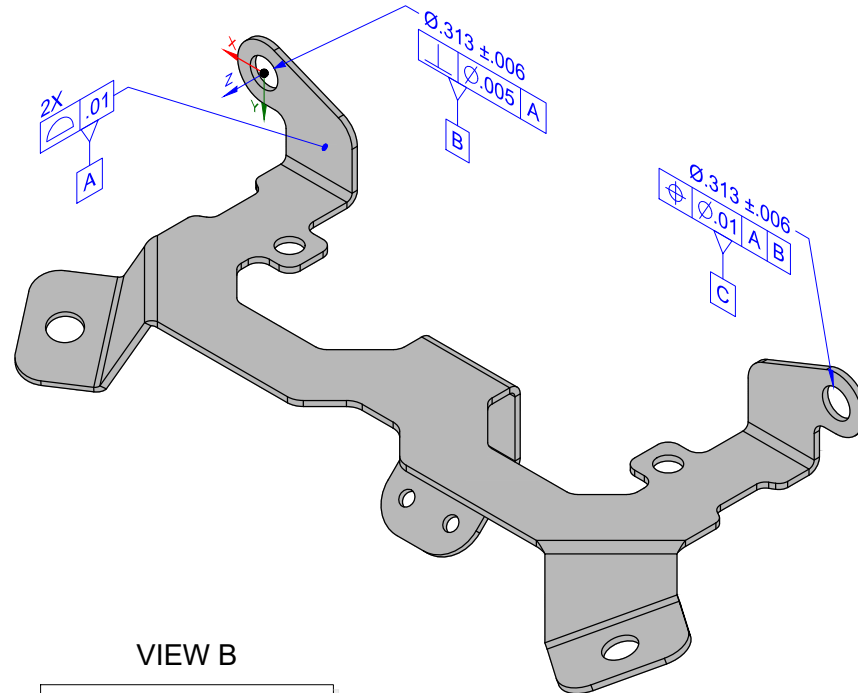

**VIEW B**

IN VIEW SERVICES	
<input type="checkbox"/>	Suppress format elements
<input type="checkbox"/>	Enable view controls
<input type="checkbox"/>	Full screen
<input type="checkbox"/>	Suppress PMI
<input type="checkbox"/>	Markup
<input type="checkbox"/>	Save view
<input type="checkbox"/>	Recall / Export view
<input type="checkbox"/>	Lock view

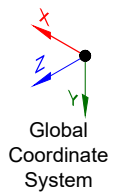

Bounding Box  
x = (7.325)  
y = (2.547)  
z = (2.965)

REVISION HISTORY				
ZONE	REV	DESCRIPTION	DATE	APPROVED
	A	Production Release	5/01/2023	-
-	-	-	-	-
-	-	-	-	-

APPROVALS:	DATE:
DRAWN: BR FISCHER	04JULY2023
CHECKED: BR FISCHER	04JULY2023
ENGINEER: BR FISCHER	04JULY2023
MODEL NO: 250-125-0015-0105-5.2	CAD KaijuCAD
PART NO: 250-125-0015-0105	REV: A
TITLE: Bracket, Mtg - Proximity Sensor	
DATASET CLASSIFICATION CODE:	DCC 5
DATASET USE CODE:	DUC 5.2
WORK MODE:	MBE
STRUCTURE:	Minimally-Dimensioned Model

General Metadata 3 of 3

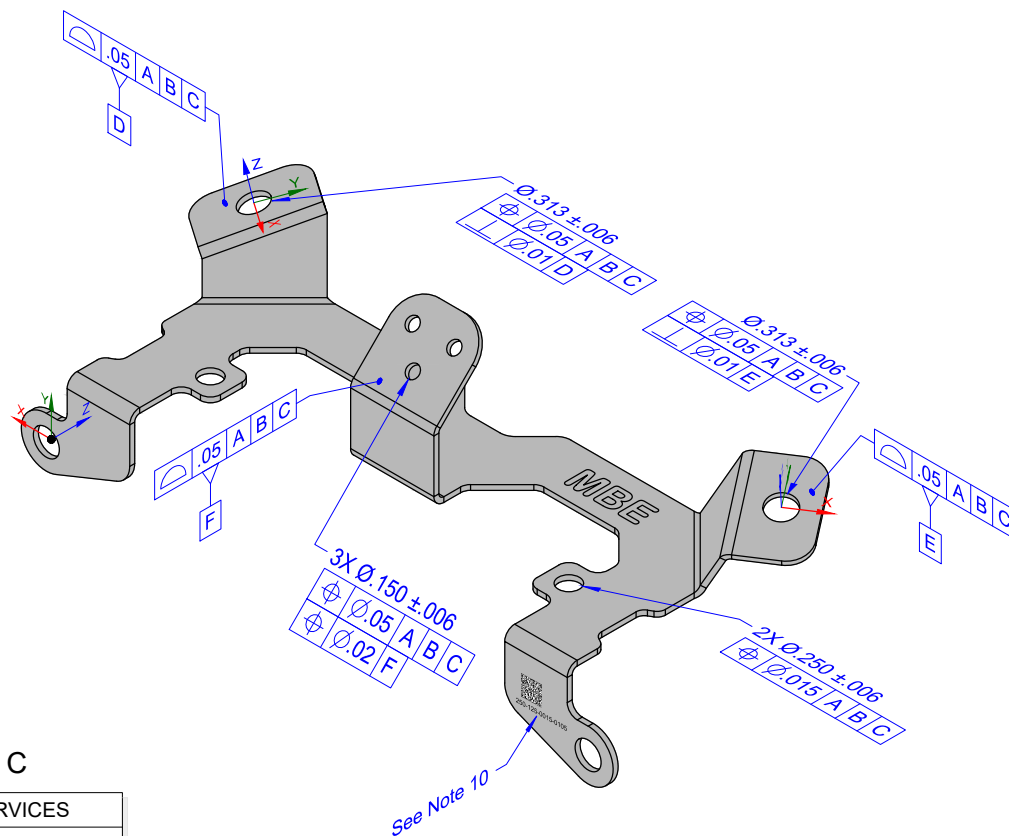

VIEW C

IN VIEW SERVICES	
<input type="checkbox"/>	Suppress format elements
<input type="checkbox"/>	Enable view controls
<input type="checkbox"/>	Full screen
<input type="checkbox"/>	Suppress PMI
<input type="checkbox"/>	Markup
<input type="checkbox"/>	Save view
<input type="checkbox"/>	Recall / Export view
<input type="checkbox"/>	Lock view

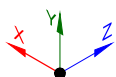

Global  
Coordinate  
System

Bounding Box  
x = (7.325)  
y = (2.547)  
z = (2.965)

REVISION HISTORY				
ZONE	REV	DESCRIPTION	DATE	APPROVED
	A	Production Release	5/01/2023	-
-	-	-	-	-
-	-	-	-	-